

HIGH VOLTAGE SURFACE MOUNT SWITCHING DIODE

FEATURE

- Fast Switching Speed
- High Conductance
- High Reverse Breakdown Voltage Rating
- We declare that the material of product compliance with RoHS requirements.
- S- Prefix for Automotive and Other Applications Requiring Unique Site and Control Change Requirements; AEC-Q101 Qualified and PPAP Capable.

Ordering Information(Pb-free)

Device	Marking	Shipping
LBAV3004T1G S-LBAV3004T1G	34W	3000/Tape&Reel
LBAV3004T3G S-LBAV3004T3G	34W	10000/Tape&Reel

LBAV3004T1G
S-LBAV3004T1G

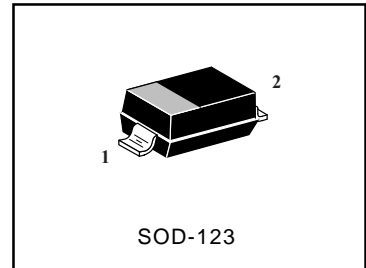

Equivalent Circuit Diagram

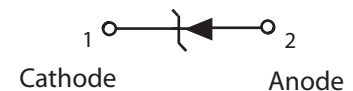

Maximum Ratings @ T_A=25°C unless otherwise specified

Characteristic	Symbol	Value	Unit
Repetitive Peak Reverse Voltage	V _{RRM}	350	V
RMS Reverse Voltage	V _{R(RMS)}	240	V
Forward Continuous Current(Note 2)	I _F	200	mA
Non-Repetitive Peak Forward Surge Current @t=1.0μs	I _{FSM}	4.0	A
@t=1.0s		1.0	
Power Dissipation(Note 2)	P _d	410	mW
Thermal Resistance Junction to Ambient Air(Note 2)	R _{θJA}	500	°C/W
Operating and Storage Temperature Range	T _j , T _{STG}	-65 to +150	°C

Electrical Characteristics @ T_A=25°C unless otherwise specified, per element

Characteristic	Symbol	Min	Typ	MAX	Unit	Test Condition
Reverse Breakdown Voltage(Note 1)	V _{(BR)R}	350			V	I _R =150μA
Forward Voltage(Note 1)	V _F		0.78 0.93 1.03	0.87 1.0 1.25	V	I _F =20mA I _F =100mA I _F =200mA
Reverse Current(Note 1)	I _R		30 35	100 100	nA μA	V _R =240V V _R =240V, T _j =150°C
Total Capacitance	C _T		1.0	5.0	Pf	V _R =0V, f=1.0MHZ
Reverse Recovery Time	T _{rr}			50	ns	I _F =I _R =30mA I _{rr} =3.0mA, R _L =100Ω

- Notes: 1. Short duration test pulse used to minimize self-heating effect.
2. Part mounted on FR-4 board with recommended pad layout.

LBAV3004T1G,S-LBAV3004T1G

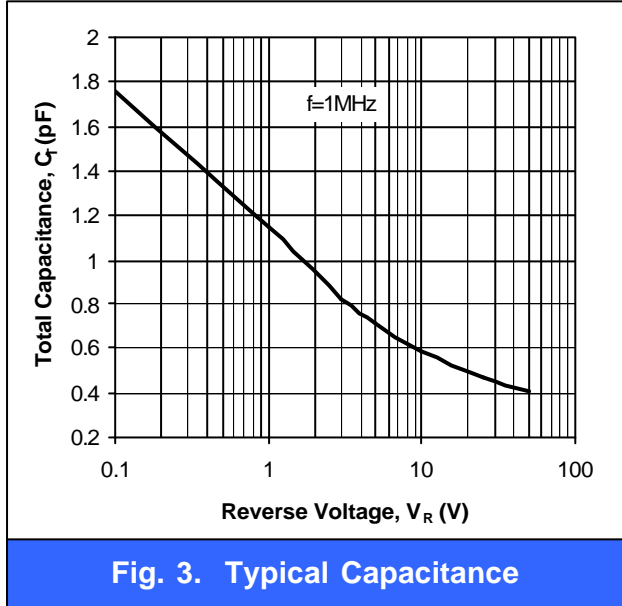
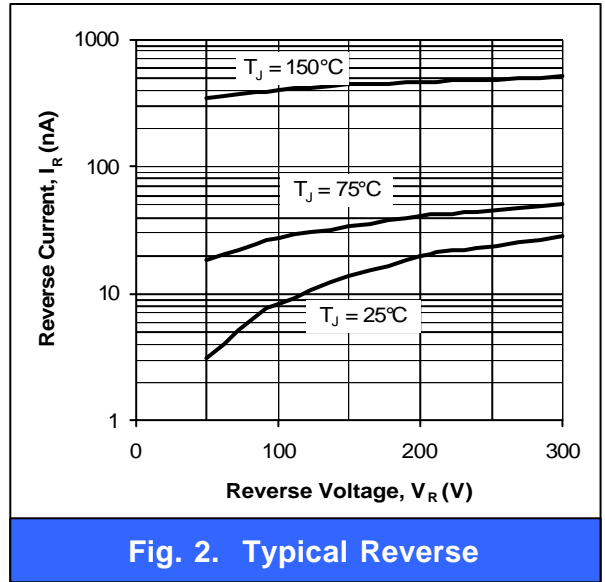
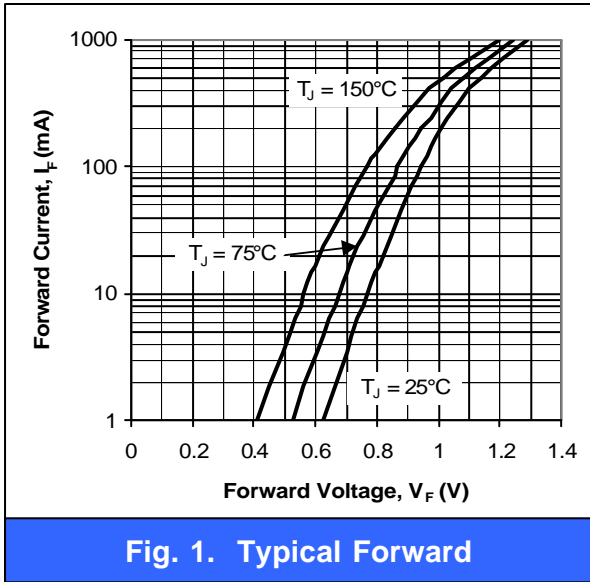

LBAV3004T1G,S-LBAV3004T1G

SOD-123

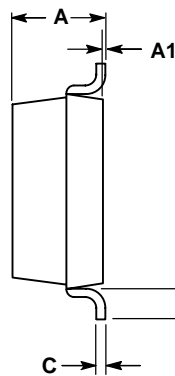
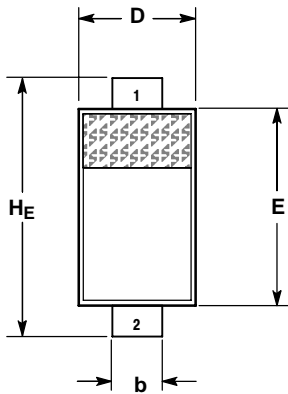

- NOTES:
 1. DIMENSIONING AND TOLERANCING PER ANSI Y14.5M, 1982.
 2. CONTROLLING DIMENSION: INCH.

DIM	MILLIMETERS			INCHES		
	MIN	NOM	MAX	MIN	NOM	MAX
A	0.94	1.17	1.35	0.037	0.046	0.053
A1	0.00	0.05	0.10	0.000	0.002	0.004
b	0.51	0.61	0.71	0.020	0.024	0.028
c	---	---	0.15	---	---	0.006
D	1.40	1.60	1.80	0.055	0.063	0.071
E	2.54	2.69	2.84	0.100	0.106	0.112
HE	3.56	3.68	3.86	0.140	0.145	0.152
L	0.25	---	---	0.010	---	---

STYLE 1:
 PIN 1. CATHODE
 2. ANODE

SOLDERING FOOTPRINT*

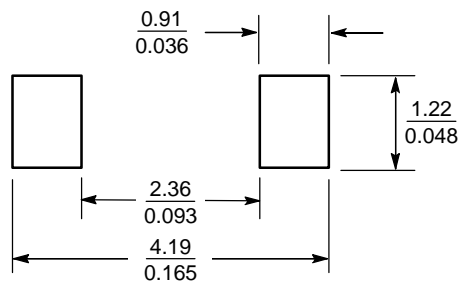

SCALE 10:1 (mm/inches)